



# PRODUCT INFORMATION



**PART #: CEPT126A067-130C40PR**

**Revision: 0-2010**

## Piezoelectric Sound Transducer



### DESCRIPTION:

Piezoelectric Sound Transducer, with Sound Port, to 3Vp-p, with SPL of 70dB(A), Resonant Frequency of 4000Hz. Terminated with pins .

### FEATURES:

- RoHS Compliant
- ISO 9001 Certified

### SPECIFICATIONS:

<b>Resonant Frequency:</b>	<b>4000±500 Hz.</b>	<b>Capacitance:</b>	<b>12000± 30% pFD</b>			
<b>Operating Voltage:</b>	<b>1-30 Vpp</b>	<b>Nominal Rated Voltage:</b>	<b>3Vpp</b>			
<b>Sound Pressure Level:</b>	<b>70dB(A), at: Nominal rated Voltage, Resonant Frequency, 10 cm</b>					
<b>Operating Current:</b>	<b>2mA, at: Nominal rated Voltage, Resonant Frequency</b>					
<b>Operating Temperature:</b>	<b>-20°C to +70°C</b>	<b>Storage Temperature:</b>	<b>-30°C to +80°C</b>			
<b>Termination:</b>	<b>Pin, Sn plated copper.</b>					
<b>Material:</b>	<b>Housing</b>	<b>Noryl</b>			<b>Color:</b>	<b>Black</b>
	<b>Diaphragm:</b>	<b>Brass</b>				
<b>Physical Dimensions:</b>	<b>Length or Diameter (L /D):</b>	<b>12.6mmφ</b>	<b>Width (W):</b>	<b>mm</b>	<b>Height (H):</b>	<b>6.7mm</b>
<b>Compliance:</b>	<b>RoHS</b>		<b>Removable Washing Label</b>	<b>No</b>	<b>Weight:</b>	<b>1.0grams</b>
<b>Packaging:</b>	<b>100pcs per styrofoam tray, 5000pcs per Carton.</b>					

**RELIABILITY:** Parts should conform to original performance within ±5dB, after 3 hours of recovery period.

<b>Thermal Operating Cycle Test:</b>	96 hours continuous operation, at Nominal Voltage, each at Minimum & Maximum Rated Operating Temperatures
<b>Thermal Storage Cycle Test:</b>	96 hours each at minimum & maximum rated Storage Temperatures, NO power applied
<b>Thermal Shock Test:</b>	Put in minimum operating temperature for 1 hour than move to +20°C for 5 min. than at maximum operating temperature for 1 hour. Then back to +20°C 5 min. Repeat for 5 cycles.
<b>Humidity Test:</b>	96 Hours at +60°C±2°C. 90-95% RH
<b>Vibration Test:</b>	Two (2) Hours at 0.75mm with 10 to 55Hz. of vibration frequency to each of 3 perpendicular directions
<b>Termination Strength:</b>	Maximum of 9.8 N load pull test, applied to each terminal in axial direction for 10 second
<b>Drop Test:</b>	Dropped naturally from 700mm height onto the surface of 10mm wooden board, 2 directions— upper and side of the part are applied
<b>Life Test:</b>	96 hours continuous operation, at Nominal Voltage, each at Minimum & Maximum Rated Operating Temperatures. And, 96 hours of: 1 minute ON 4 minutes OFF cycle, at Room Temperature, and Maximum Rated Voltage.
<b>Warranty:</b>	For a period of one (1) year from date of manufacture under normal operating conditions

### FREQUENCY REPOSE CURVE:

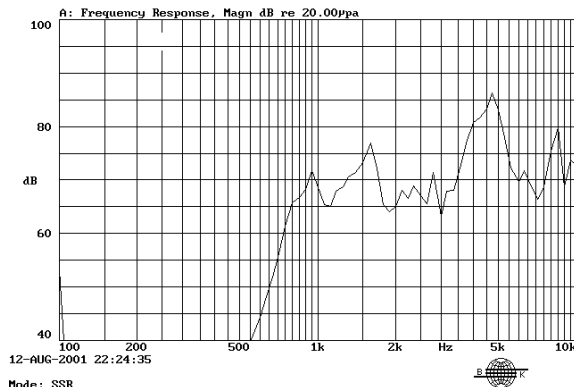

### DIMENSIONS: Units in: mm Tolerance: ±0.5mm

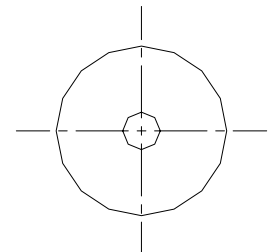
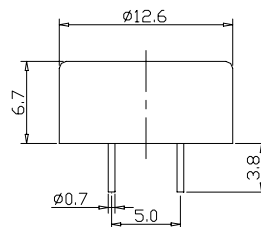



**Packaging:**

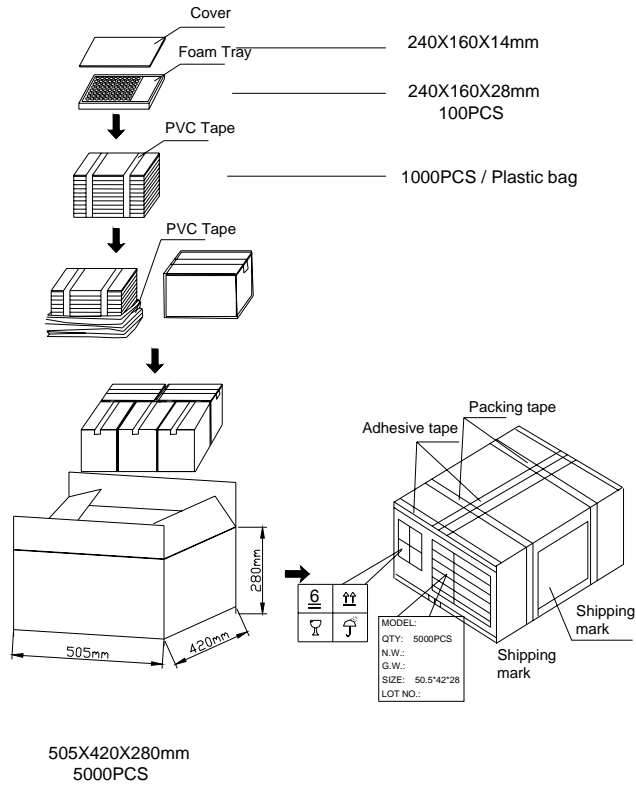

**Notes:**

- 1.
- 2.
- 3.
- 4.
- 5.
- 6.