

CI14P-30S400-C-1

Rev. 0-2024
RoHS3 & REACH
Piezoelectric Indicators

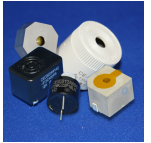

Operating Characteristics

ELECTRICAL

Rated Voltage	24 VDC
Operating Voltage	4 to 30 VDC
Max Current at Vrated	5 mA

ACOUSTIC

Tone Category	Continuous
Description	Steady
Center <i>f</i>	4000 ± 500 Hz
Min SPL at Vrated	95 dB
Test Conditions	10 cm

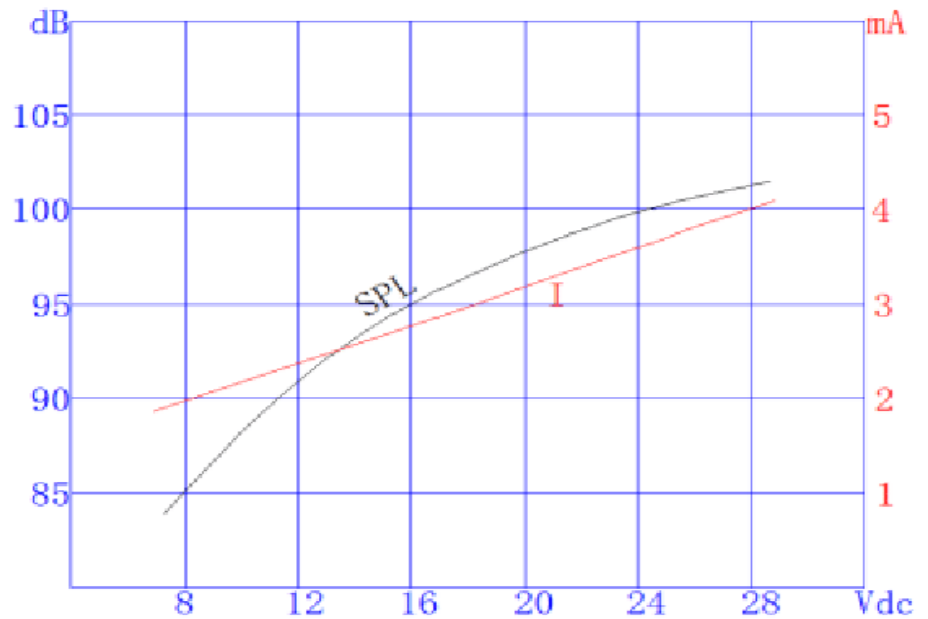

Physical Characteristics

MATERIALS

Housing	LCP Vectra E130i; UL 94-V0 (UL No.:E106764)
Diaphragm	Nickel Alloy Disc N42
Solder Pads	Tin Plated Brass

TEMPERATURE RANGES

Operating	-40 to +85 °C
Storage	-40 to +90 °C

Weight 1.6 g

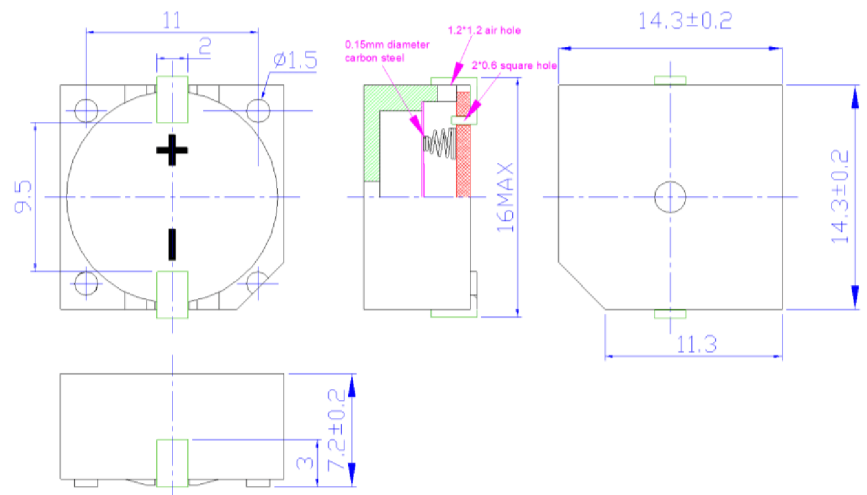

General tolerance = ±0.5 mm and all measurements in mm unless otherwise noted.

Revision	Description	By	Date
0-2024	Original Specification	AL	2024-05-10

Warranty: For a period of one (1) year from date of shipping under normal operations conditions. This warranty does not apply to products damaged through misuse, abuse, improper installation, alteration, rework, or attempt to repair.

The information contained herein is believed to be correct, but no guarantee or warranty, express or implied, with respect to accuracy, completeness or results is extended and no liability is assumed. Challenge Electronics reserves the right to make changes in any specification, data or material contained herein.

CI14P-30S400-C-1

Rev. 0-2024
RoHS3 & REACH
Piezoelectric Indicators



Recommended Footprint

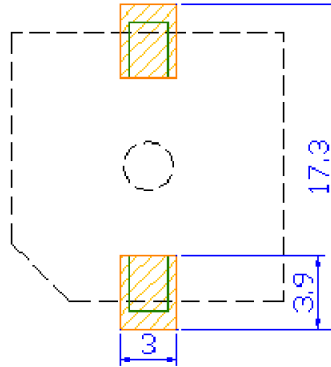

Recommended Reflow Profile

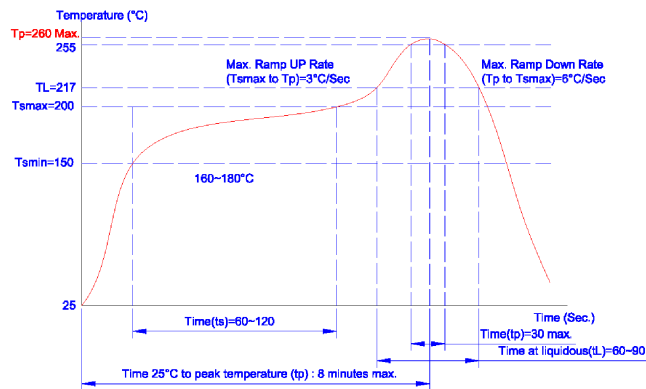

Tape & Reel Packaging

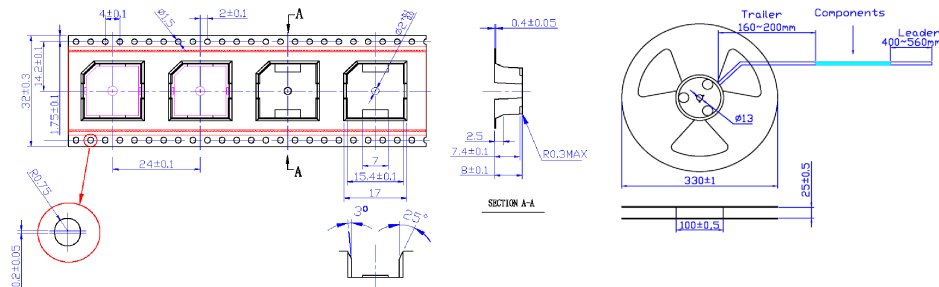

- NOTE:
- 1.10 sprocket hole pitch cumulative tolerance +/-0.20mm.
 - 2.Carrier camber not to exceed 1 mm in 250 mm.
 3. All dimensions meet EIA-481-2-A requirements.
 4. Thickness: 0.40+/-0.05 mm.
 5. Component loaded per 13" reel: 350 pcs

Revision	Description	By	Date
0-2024	Original Specification	AL	2024-05-10

Warranty: For a period of one (1) year from date of shipping under normal operations conditions. This warranty does not apply to products damaged through misuse, abuse, improper installation, alteration, rework, or attempt to repair.

The information contained herein is believed to be correct, but no guarantee or warranty, express or implied, with respect to accuracy, completeness or results is extended and no liability is assumed. Challenge Electronics reserves the right to make changes in any specification, data or material contained herein.