

## CI26M-16T40-C-1

Former P/N: CEMB26K197-12C04PR / CEMB26K-12

Rev. 7-2022  
RoHS3 & REACH  
Mechanical Indicators



### Operating Characteristics

#### ELECTRICAL

Rated Voltage	12 VDC
Operating Voltage	8 to 16 VDC
Max Current at Vrated	40 mA

#### ACOUSTIC

Tone Category	Continuous
Description	Steady
Center $f$	400 ± 100 Hz
Min SPL at Vrated	95 dB
Test Conditions	10 cm

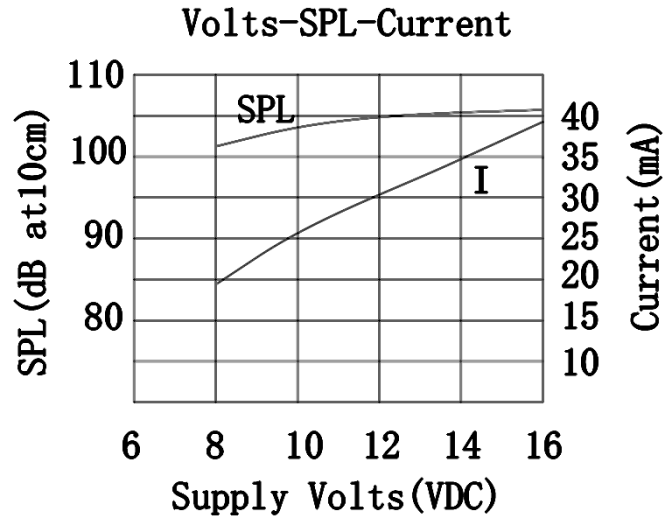

### Physical Characteristics

#### MATERIALS

Housing	Noryl
Diaphragm	Stainless Steel
PC Pin	Copper/Brass

#### TEMPERATURE RANGES

Operating	-30 to +70 °C
Storage	-40 to +85 °C

Weight 17 g

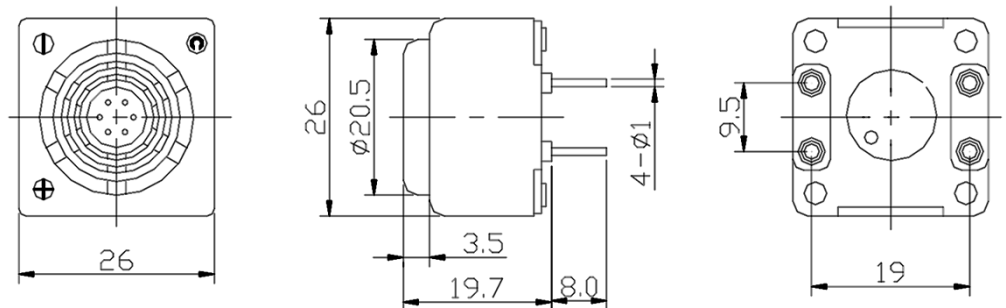

General tolerance = ±0.5 mm and all measurements in mm unless otherwise noted.

Revision	Description	By	Date
6-2022	Updated mechanical drawing and frequency response curve. Updated callout from a max current of 45mA at maximum voltage to max current of 40 mA at rated voltage.	CT	2022-02-22
7-2022	Updated housing material callout from ABS to Noryl. Updated operating temp. from -20°C to 60°C to -30°C to 70°C. Updated storage temp. range from -30°C to 70°C to -40°C to 85°C.	CT	2022-05-06

Warranty: For a period of one (1) year from date of shipping under normal operations conditions. This warranty does not apply to products damaged through misuse, abuse, improper installation, alteration, rework, or attempt to repair.

The information contained herein is believed to be correct, but no guarantee or warranty, express or implied, with respect to accuracy, completeness or results is extended and no liability is assumed. Challenge Electronics reserves the right to make changes in any specification, data or material contained herein.