

INDICATORS • SPEAKERS • SOUND TRANSDUCERS • ENCLOSURES • MICROPHONES • BATTERY ACCESSORIES

## CI36P-30E290-C-20X

Former P/N: CE-CX330AQ

Rev. 9-2021  
RoHS3 & REACH  
300 HR ASTM B117 & IP68  
Piezoelectric Indicators



### Operating Characteristics

#### ELECTRICAL

Rated Voltage	24 VDC
Operating Voltage	3 to 30 VDC
Max Current at Vmax	50 mA

#### ACOUSTIC

Tone Category	Continuous
Description	Steady
Center $f$	2900 $\pm$ 500 Hz
Min SPL at Vmin	80 dB
Min SPL at Vmax	100 dB
Test Conditions	61 cm

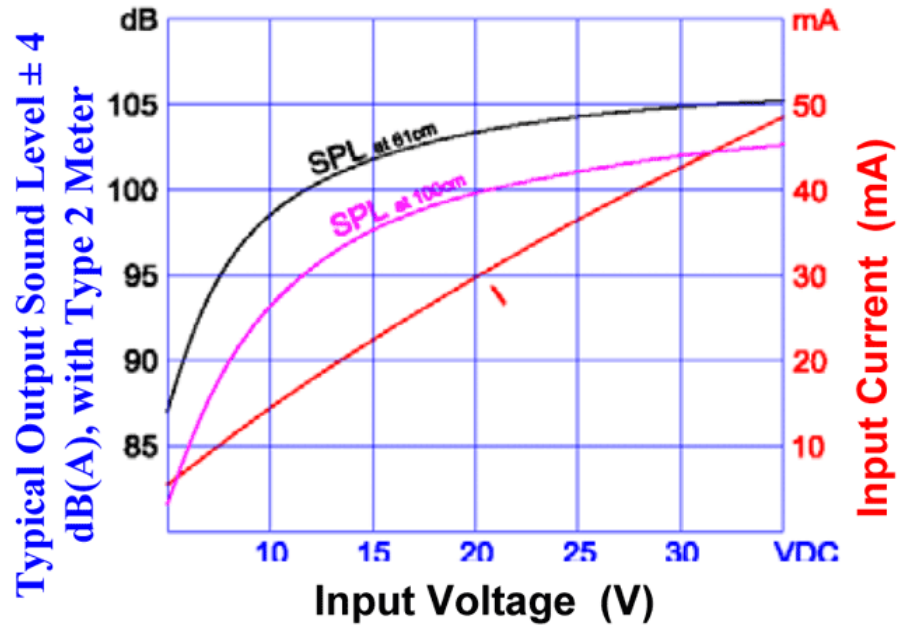

### Physical Characteristics

#### MATERIALS

Housing	Noryl PX9406
Diaphragm	Stainless Steel
Terminal	Brass

#### TEMPERATURE RANGES

Operating	-30 to +65 °C
Storage	-40 to +105 °C

Weight 35 g

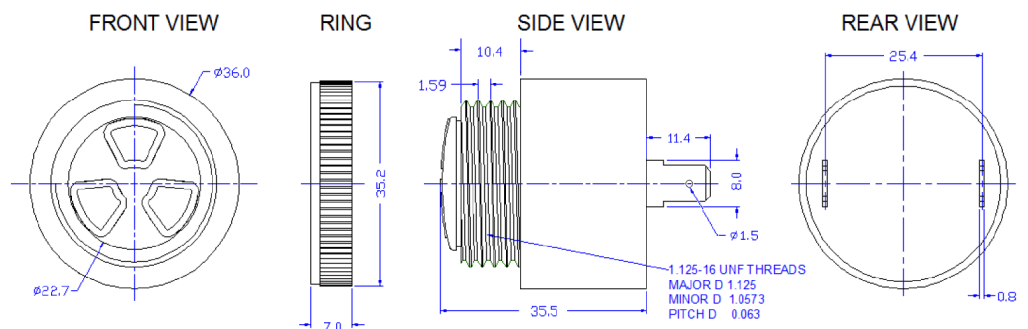

All Measurements are mm unless noted otherwise.

Revision	Description	By	Date
8-2019	Migrate to new format	JL	2019-06-21
9-2021	Updated IP rating from IP65 to IP68. Added general tolerance and removed inch dimensions from mechanical drawing.	CT	2021-08-11

Warranty: For a period of two (2) years from date of shipping under normal operations conditions. This warranty does not apply to products damaged through misuse, abuse, improper installation, alteration, rework, or attempt to repair. IP Rating ensures functionality after water has been drained fully from device.