

## CT16P-25S410-1

Former P/N: CT13PS-25410-1

Rev. 3-2023  
RoHS3 & REACH  
Piezoelectric Sound Transducers

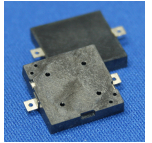

### Operating Characteristics

#### ELECTRICAL

Rated Voltage	5 Vp-p
Max Operating Voltage	25 Vp-p
Max Current at V Rated	3 mA
Capacitance	16000 pF ± 30 % 120 Hz

#### ACOUSTIC

Min SPL at V Rated	80 dB
Test Conditions	10 cm
$f_0$	4100 Hz

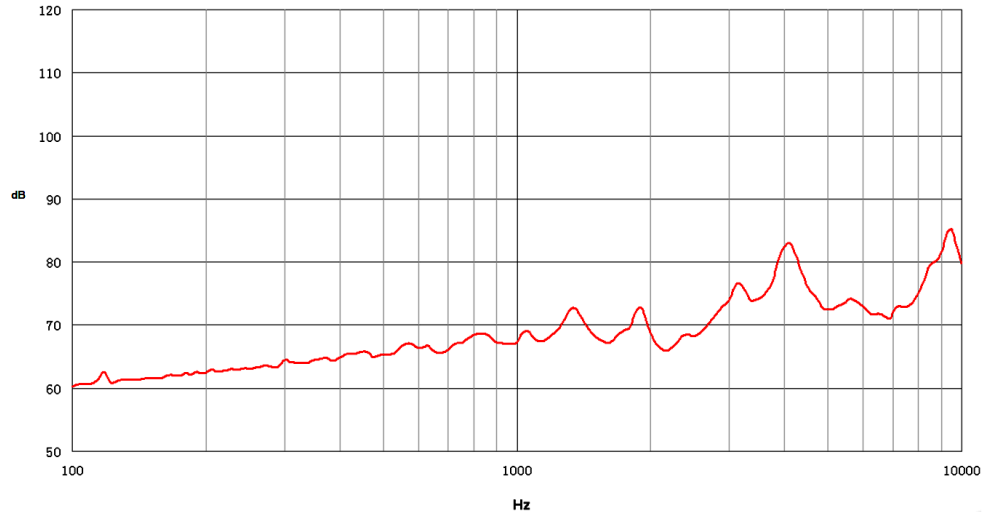

### Physical Characteristics

#### MATERIALS

Housing	LCP
Diaphragm	Nickel
Solder Pad	Brass

#### TEMPERATURE RANGES

Operating	-40 to +85 °C
Storage	-40 to +85 °C

Weight	0.5 g
--------	-------

Unless otherwise specified, tolerance: ± 0.5(unit: mm)

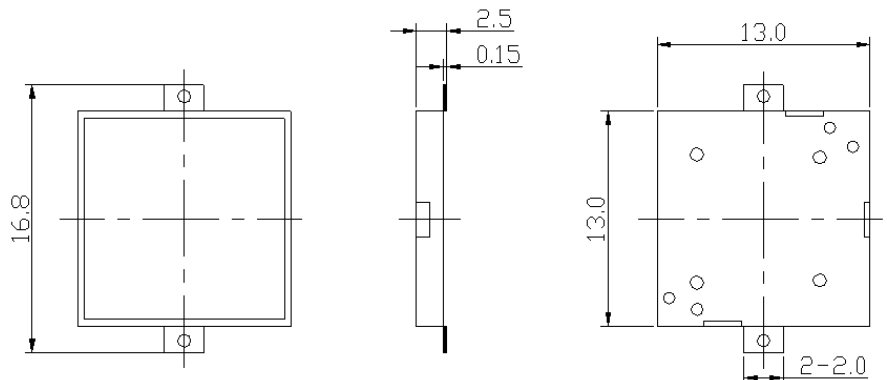

All measurements in mm unless otherwise noted.

Revision	Description	By	Date
2-2021	Added solder profile, PCB land pattern, and packaging. Updated operating temp. range from -30°C to +70°C to -40°C to +85°C	CT	2021-10-08
3-2023	Added part image.	SK	2023-05-09

Warranty: For a period of one (1) year from date of shipping under normal operations conditions. This warranty does not apply to products damaged through misuse, abuse, improper installation, alteration, rework, or attempt to repair.

The information contained herein is believed to be correct, but no guarantee or warranty, express or implied, with respect to accuracy, completeness or results is extended and no liability is assumed. Challenge Electronics reserves the right to make changes in any specification, data or material contained herein.