

CT22P-25T200-1

Former P/N: CPT22EM03-2.0-P3.5R

Rev. 4-2019
RoHS3 & REACH
Piezoelectric Sound Transducers

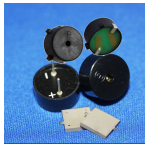

Operating Characteristics

ELECTRICAL	
Rated Voltage	3 Vp-p
Max Operating Voltage	25 Vp-p
Max Current at V Rated	2 mA
Capacitance	22000 pF ± 30 % 100 Hz
ACOUSTIC	
Min SPL at V Rated	80 dB
Test Conditions	10 cm
f_o	2000 ± 500 Hz

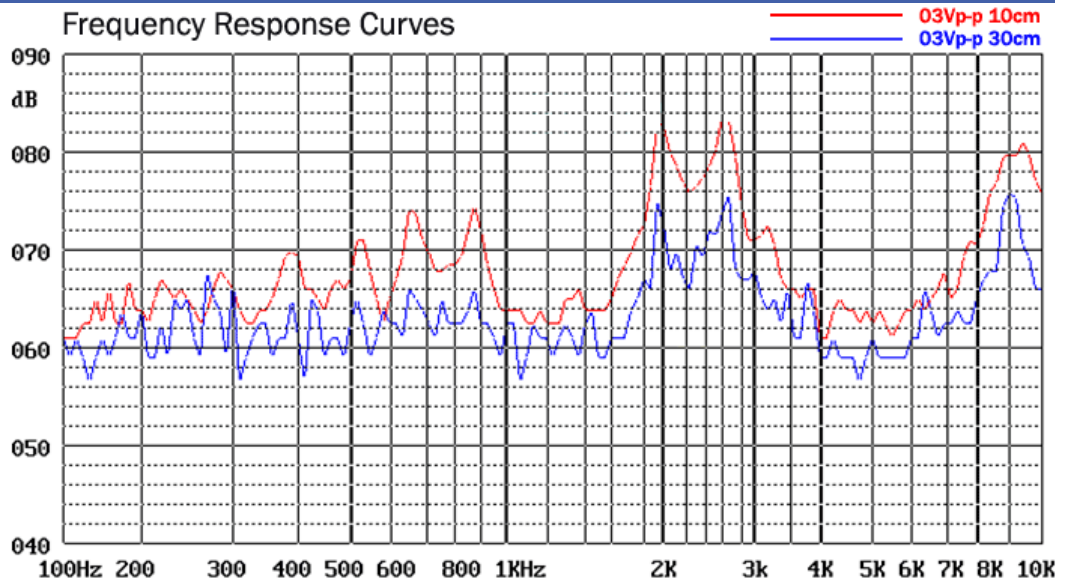

Physical Characteristics

MATERIALS	
Housing	Plastic, MPPO
Diaphragm	Brass Disc
PC Pin	Tin Plated Stainless Steel
TEMPERATURE RANGES	
Operating	-40 to +125 °C
Storage	-40 to +125 °C

Weight 2.5 g

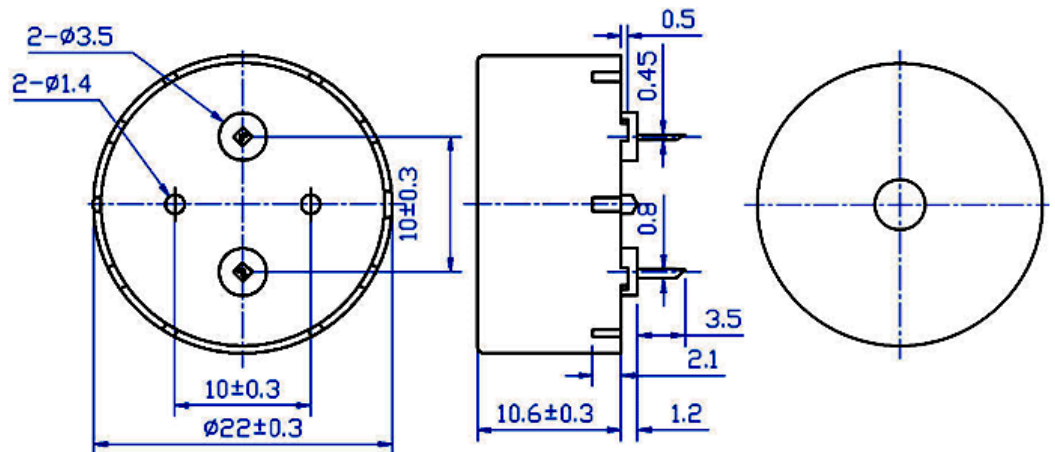

Revision	Description	By	Date
3-2016	Changed capacitance from 19,000 to 22,000 pF. Updated frequency response chart. Corrected resonant frequency from 2,400 to 2,000 Hz. Added REACH compliance.	WS	2016-01-28
4-2019	Migrate to new format	JL	2019-06-21

Warranty: For a period of one (1) year from date of shipping under normal operations conditions This warranty does not apply to products damaged through misuse, abuse, improper installation, alteration, rework, or attempt to repair.

The information contained herein is believed to be correct, but no guarantee or warranty, express or implied, with respect to accuracy, completeness or results is extended and no liability is assumed. Challenge Electronics reserves the right to make changes in any specification, data or material contained herein.