

CS12-00P120-04-1

 Rev. 1-2023
 RoHS3 & REACH
 Planar Magnetic Speakers



Operating Characteristics

ELECTRICAL

Rated Power	0.005 W
Short Term Max Power	0.01 W
Impedance	17 Ω \pm 15 % 1200 Hz; 0.002 W

ACOUSTIC: IEC-318 Artificial Ear

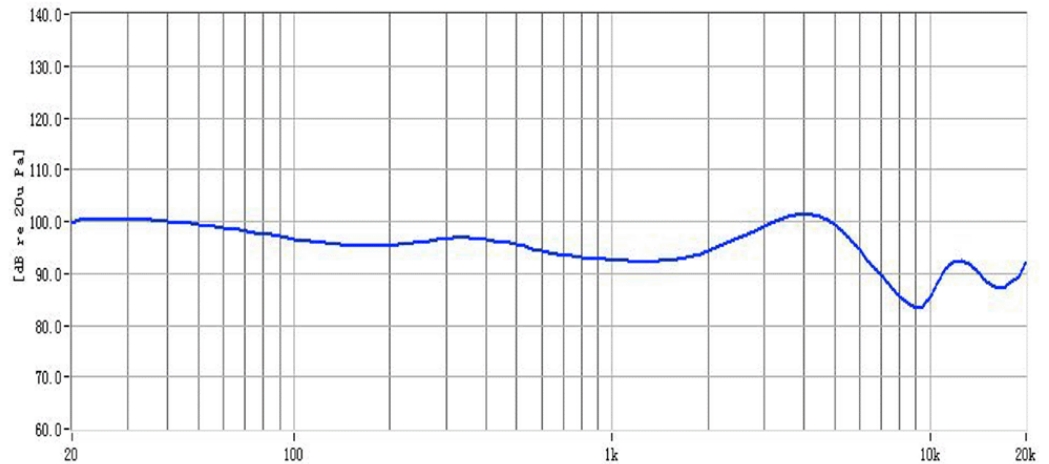
f_o	1200 Hz \pm 15 % 0.002 W
Freq. Range	20 to 20000 Hz
Rated SPL	93 \pm 2 dB 1000 Hz; AVG; 0.002 W;
Distortion	Max 1 % 1000 Hz; 0.002 W



Physical Characteristics

MATERIALS

Housing	Stainless Steel
Cone	PET+PU
Magnet	NdFeB
Solder Pad	Tin Plated Copper

TEMPERATURE RANGES

Operating	-25 to +60 °C
Storage	-25 to +60 °C

Weight	2 g
--------	-----

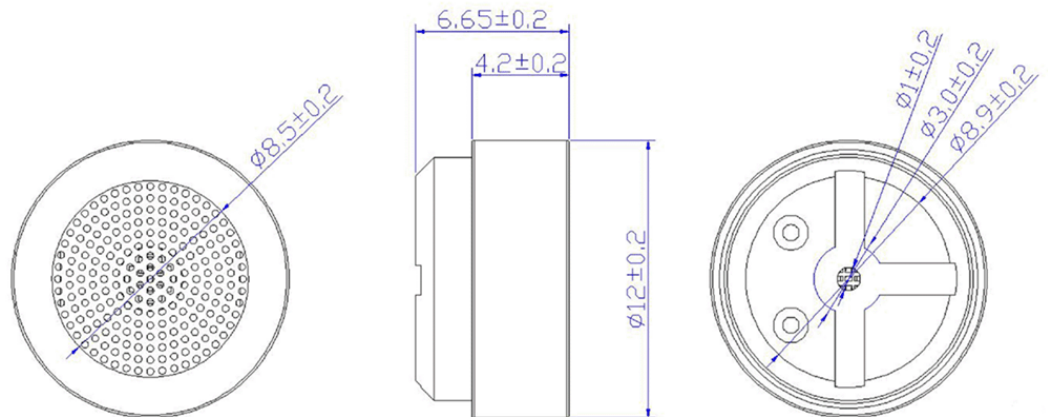
 General tolerance = ± 0.2 mm and all measurements in mm unless otherwise noted.

Revision	Description	By	Date
0-2023	Original Specification.	SK	2023-08-17
1-2023	Updated Impedance from 32 \pm 15% to 17 \pm 15% Ω , SPL from 98 \pm 2 to 93 \pm 2dB and test input from 0.001 to 0.002W, Frequency Response diagram, and Mechanical Drawing: added new overall height of 6.65mm, removed rear 4mmSK diameter, and added new rear diameters of 1, 3, and 8.9mm.		2023-11-10

Warranty: For a period of one (1) year from date of shipping under normal operations conditions. This warranty does not apply to products damaged through misuse, abuse, improper installation, alteration, rework, or attempt to repair.

The information contained herein is believed to be correct, but no guarantee or warranty, express or implied, with respect to accuracy, completeness or results is extended and no liability is assumed. Challenge Electronics reserves the right to make changes in any specification, data or material contained herein.