

INDICATORS • SPEAKERS • SOUND TRANSDUCERS • ENCLOSURES • MICROPHONES • BATTERY ACCESSORIES

CS16-00R85-03-4

Former P/N: CES160V030AH08PMN850SR

Rev. 3-2020
RoHS3 & REACH
Mobile Speakers



Operating Characteristics

ELECTRICAL

Rated Power	0.5 W
Short Term Max Power	0.8 W
Impedance	8 Ω ± 15 % 2000 Hz; 0.5 W

ACOUSTIC: 1cc Sealed Enclosure

f_0	850 Hz ± 20 % 0.5 W
Freq. Range	850 to 10000 Hz
Rated SPL	90 ± 3 dB 2000 Hz; 0.5 W; 10 cm;
Distortion	<5 % 1000 Hz; 0.125 W

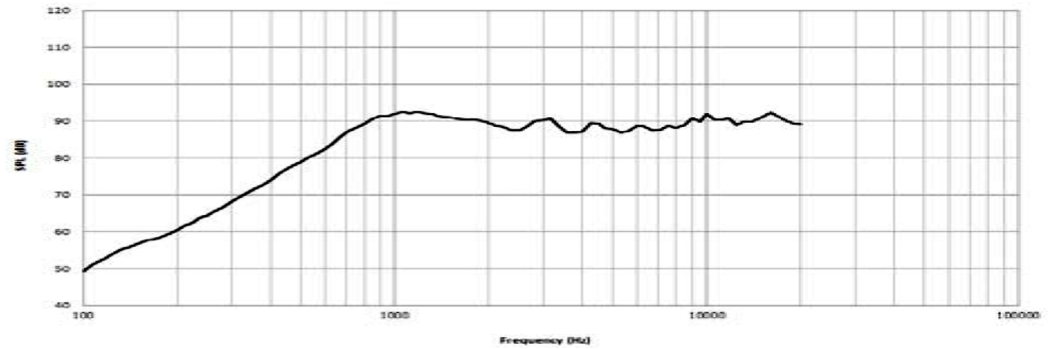

Physical Characteristics

MATERIALS

Housing	Plastic
Cone	Mylar
Magnet	3x NdFeB
Spring	Stainless Steel

TEMPERATURE RANGES

Operating	-20 to +70 °C
Storage	-40 to +85 °C

Weight 1.5 g

contact layout

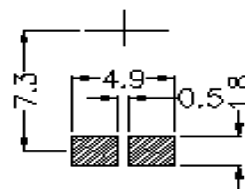

Free Position

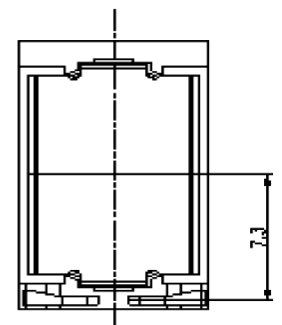
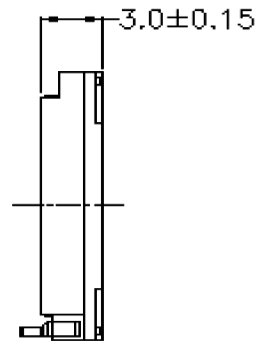
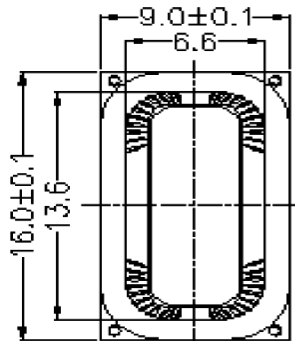
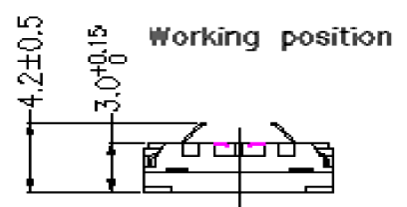

Revision	Description	By	Date
2-2019	Migrate to new format	WS	2019-06-21
3-2020	Added magnet quantity to materials section.	JL	2020-04-02

Warranty: For a period of one (1) year from date of shipping under normal operations conditions This warranty does not apply to products damaged through misuse, abuse, improper installation, alteration, rework, or attempt to repair.