

INDICATORS • SPEAKERS • SOUND TRANSDUCERS • ENCLOSURES • MICROPHONES • BATTERY ACCESSORIES

CS50-01D38-18-1

Former P/N: CLS50RN18.2E-8F1.5-B380R

 Rev. 6-2019
 RoHS3 & REACH
 Round Speakers

Operating Characteristics

ELECTRICAL

Rated Power	1.5 W
Short Term Max Power	3.0 W
Impedance	8 Ω ± 15 % Hz: 3 W

ACOUSTIC: Baffle Board

f_0	380 Hz ± 20 % 3 W
Freq. Range	380 to 5000 Hz
Rated SPL	104 ± 3 dB 800, 1000, 1200, 1500 Hz; 1.5 W; 10 cm;
Distortion	<15 % 1000 Hz; 1.5 W

SPL at 0.1m 1W

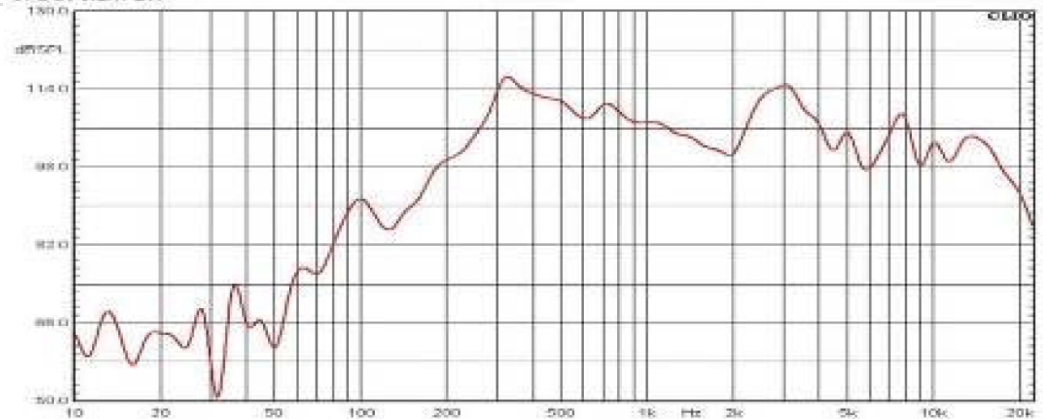

Physical Characteristics

MATERIALS

Housing	Plastic
Cone	Mylar
Magnet	Ferrite
Solder Tab	Tin Plated Brass

TEMPERATURE RANGES

Operating	-20 to +60 °C
Storage	-30 to +70 °C

Weight 45 g

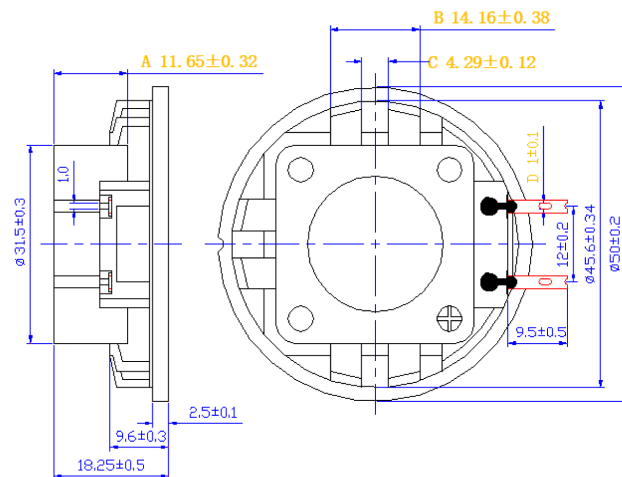

Revision	Description	By	Date
5-2019	Correct the SPL from 111+/-3 dB @4.9V 0.1m(106+/-3dB @2.83V 0.1m)to 109+/-3 dB@4.9V 0.1m(104+/-3dB @2.83V 0.1m)	CD	2018-07-19
6-2019	Migrate to new format.	CF	2019-06-24

Warranty: For a period of one (1) year from date of shipping under normal operations conditions This warranty does not apply to products damaged through misuse, abuse, improper installation, alteration, rework, or attempt to repair.

The information contained herein is believed to be correct, but no guarantee or warranty, express or implied, with respect to accuracy, completeness or results is extended and no liability is assumed. Challenge Electronics reserves the right to make changes in any specification, data or material contained herein.

©2019 Challenge Electronics, Inc. 20190826155246