

INDICATORS • SPEAKERS • SOUND TRANSDUCERS • ENCLOSURES • MICROPHONES • BATTERY ACCESSORIES

CS50-01D58-10-1

Former P/N: CS500-0158-101

Rev. 1-2019
RoHS3 & REACH
Round Speakers



Operating Characteristics

ELECTRICAL

Rated Power	1.0 W
Short Term Max Power	2.0 W
Impedance	8 Ω ± 15 % 1000 Hz; 0.125 W

ACOUSTIC: 1000CC Sealed Enclosure

f_0	580 Hz ± 20 % 0.125 W
Freq. Range	580 to 10000 Hz
Rated SPL	94 ± 3 dB 800, 1000, 1200, 1500 Hz; 0.1 W; 10 cm;
Distortion	<5 % 1000 Hz; 0.1 W

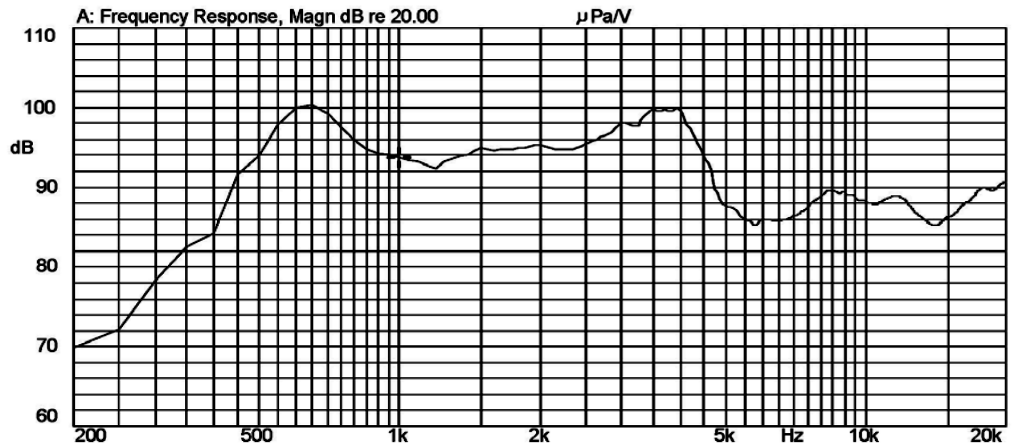

Mode: TSR



Physical Characteristics

MATERIALS

Housing	Metal
Cone	Paper
Magnet	NdFeB
Solder Tab	Tin Plated Copper

TEMPERATURE RANGES

Operating	-20 to +60 °C
Storage	-20 to +70 °C

Weight 16.1 g

MARKING

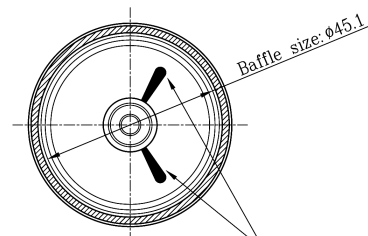
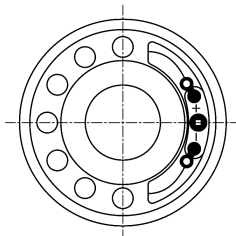
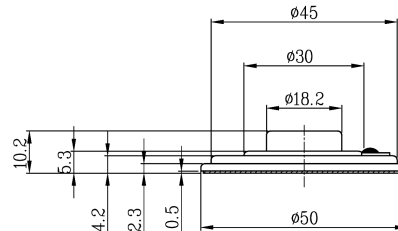
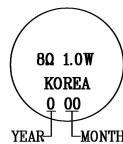

Black lacquer bonding

*NOTE: RoHS Compliant.

Revision	Description	By	Date
0-2018	Initial Specification Sheet	JL	2018-07-30
1-2019	Migrate to new format.	CF	2019-06-24

Warranty: For a period of one (1) year from date of shipping under normal operations conditions This warranty does not apply to products damaged through misuse, abuse, improper installation, alteration, rework, or attempt to repair.

The information contained herein is believed to be correct, but no guarantee or warranty, express or implied, with respect to accuracy, completeness or results is extended and no liability is assumed. Challenge Electronics reserves the right to make changes in any specification, data or material contained herein.

©2019 Challenge Electronics, Inc. 20190909103612